

Fibreglass cable protection channels

OEC Product Catalogue

Channel "OMEGA" in Fibreglass Series CV/05-10

CHANNEL "OMEGA" in FIBREGLASS for CABLE PROTECTION

Article code: See Table

Series	Code	Dimensions (mm)					
		Length	a	b	h	R	S min.
CV0/5	T0PO0001	3000	56	42	56	26	3
CV0/10	T0PO0080	3000	100	88	100	50	3,5

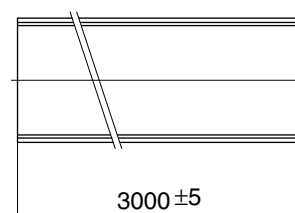

Technical characteristics:

- Polyester resin reinforced with glass fibre Grey Ral 7001.
- Fire resistance, according to Indications ASTM D-635: < 240 seconds.
- Impact resistance IK 10 according to CEI EN 62262.
- Reference to Enel Technical Specification: Tab. DS 4237 National.

Caratteristiche del manufatto:

- The cable is manufactured via fibreglass poltrusion.
- Due to the material employed, the production technique and its Omega shape; the channel is characterised by high resistance to pressure and corrosion, and high electrical isolation.
- The channel is generally used to protect Low and Medium voltage cables. It is mounted by means of metal brackets. Upon request it may be supplied with slots for installation with a stainless-steel strip.

Accessories for wall mounting:

- T6PO0001 - Omega brackets 50.
- T6PO0003 - Omega brackets 100.

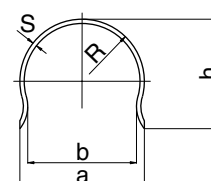

CV0/5



CV0/10



Cable protection channel in Fibreglass

Series CV/Q50-200 - Series CV/R70-175

CABLE PROTECTION CHANNEL in FIBREGLASS

Article code: See Table

Series	Dimensions (mm)						
	Height (A)	Width (B)	Code Type A	Thickness	Code Type B	Thickness	Width
CV/Q 50x50	50	50	TOPO0050	2,5	TOPO0052	3,0	2000
CV/Q 80x80	80	80	TOPO0051	2,5	TOPO0053	3,0	2000
CV/Q 120x120	120	120	TOPO0054	2,5	TOPO0055	3,0	2000
CV/Q 140x140	140	140	TOPO0056	2,5	TOPO0057	3,0	2000
CV/Q 175x175	175	175	TOPO0062	2,5	----	--	2000
CV/Q 200x200	200	200	NOPO0014	2,5	NOPO0013	3,0	2000
CV/R 70x140	70	140	TOPO0060	2,5	TOPO0061	3,0	2000
CV/R 70x175	70	175	TOPO0064	2,5	----	--	2000
CV/R 100x140	100	140	TOPO0058	2,5	TOPO0059	3,0	2000
CV/R 120x175	120	175	TOPO0063	2,5	----	--	2000

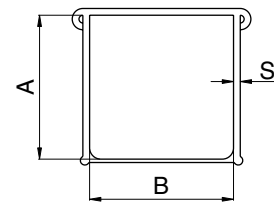

Technical characteristics:

- Polyester resin reinforced with glass fibre (Fibreglass) of any colour. Standard color is Grey Ral 7035.
- Fire resistance according to Indications ASTM D-635: < 480 seconds.

General characteristics:

- The channel is made of a 2-meter-long base and a 2-meter-long cover in pultruded fibreglass.
- The characteristics of the material employed, the production technique and its shape, confer it high mechanical characteristics, high electric insulation, absence of need to be grounded, atmospheric and chemical agent resistance, no maintenance, low cost, light weight, modern and functional design, smooth and uniform surfaces.
- The structure of the NTET channel allows a wide range of application both underground and above ground on walls, viaducts and buildings.
- Certifications and Technical Specifications of reference: The NTET channels have been approved by the Italian national railway service and Telecom Italia S.p.A. and comply with both FS Technical Specifications for railway networks n° TT 517, IS 213 and IS/TT 222 (for internal use), and the Telecom Italia technical specifications for telecommunications networks n° 1398. They are also used by the more important firms.

Accessories:

- Channel joining elements.

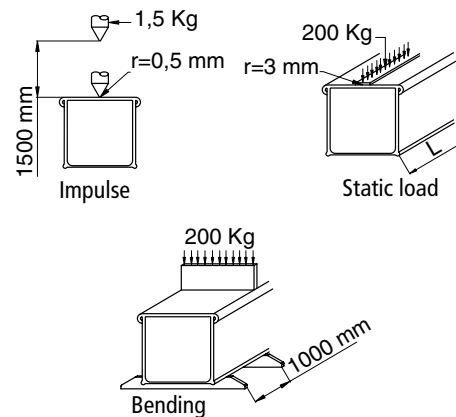

CV/Q-CV/R

Fibreglass cable protection channel Series CV/H80 X 100-300

MULTIPURPOSE SUSPENSION CABLE DUCTS BLANK/SLOTTED

Article code: See Table

Code	Dimensions (mm)								
	Nominal Width (A)	Working dimension		Overall dimension			Surface		Notes
		(w)	(h)	(L)	(H)	(W)	total (S)	working (Su)	
Channel									
SB100	100	100	80	2000	95	110	8000	4000	closed bottom
SB200	200	200	80	2000	95	210	16000	8000	closed bottom
SB300	300	300	80	2000	95	310	24000	12000	closed bottom
SBH100	100	100	80	2000	95	110	8000	4000	perforated bottom
SBH200	200	200	80	2000	95	210	16000	8000	perforated bottom
SBH300	300	300	80	2000	95	310	24000	12000	perforated bottom
Covers									
CSB100	100	--	--	2000	18	110	---	---	---
CSB200	200	--	--	2000	18	210	---	---	---
CSB300	300	--	--	2000	18	310	---	---	---

Technical characteristics:

- Fibreglass, no halogens, in compliance with CEI 23-32 and CEI 23-37 for self-extinguishment and toxicity, Grey RAL 7035.
- Protection level IP 40D and impact resistance of 6 J according to regulation CEI 23-32.

General characteristics:

- The channel is made of a 2-meter long beam with perforated bottom to facilitate mounting, a 2-meter cover and a series of accessories shown below. With these few elements it is possible to install a simple wall or ceiling-mounted cable duct, or a suspended multipurpose duct, including horizontal and vertical deviation elements, branching elements etc. Poltruded profiles confer lightness, good corrosion resistance, good dielectric and mechanical characteristics optimized by the anisotropic structure and a good impact, wear and temperature resistance from - 40 °C to + 110 °C.
- Certifications: The multipurpose suspension duct is marked CE and classified (with respect to the channel) in accordance with regulation CEI 23-32 of the IMQ.

Accessories:

- 90° horizontal, internal and external vertical bends - Covers for 90° horizontal, internal and external vertical bends - 45° horizontal bends - Covers for 45° horizontal bends - Left and right reduction elements - Covers for left and right reduction elements - Separators - T branches - Covers for T branches - Mounting clip - Equipment support plates. All accessories are fibreglass. Horizontal and vertical deviation elements - Wall-mounted shelf - Rack-mounted shelf - Single or double suspension plate - Wall mount - Single or double suspension mount - Mounting bolts for shelf clamps. All is stainless-steel.

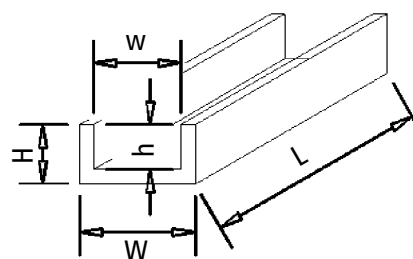
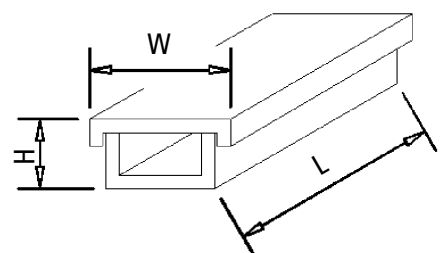

CV/H80 X 100-300

Fibreglass cable protection channel

Series CV/H110 X 200-400

MULTIPURPOSE SUSPENSION CABLE DUCTS BLANK/SLOTTED

Article code: See Table

Code	Dimensions (mm)								
	Nominal Width (A)	Working dimensions		Overall dimensions			Surface		Notes
		(w)	(h)	(L)	(H)	(W)	total (S)	working (Su)	
Channel									
HSB200	200	200	110	2000	125	210	22000	11000	closed bottom
HSB300	300	300	110	2000	125	310	33000	16000	closed bottom
HSB400	400	400	110	2000	125	410	42000	21000	closed bottom
HSBH200	200	200	110	2000	125	210	22000	11000	perforated bottom
HSBH300	300	300	110	2000	125	310	33000	16000	perforated bottom
HSBH400	400	400	110	2000	125	410	42000	21000	perforated bottom
Covers									
CSB200	200	--	--	2000	18	220	---	---	---
CSB300	300	--	--	2000	18	320	---	---	---
CSB400	400	--	--	2000	18	420	---	---	---

Technical characteristics:

- Fibreglass, no halogens, in compliance with CEI 23-32 and CEI 23-37 for self-extinguishment and toxicity, Grey RAL 7035.
- Protection level IP 40D impact resistance 6 J according to specification CEI 23-32.

General characteristics:

- The channel is made of a 2-meter long beam with perforated bottom to facilitate mounting, a 2-meter cover and a series of accessories shown below. With these few elements it is possible to install a simple wall or ceiling-mounted cable duct, or a suspended multipurpose duct, including horizontal and vertical deviation elements, branching elements etc. Poltruded profiles confer lightness, good corrosion resistance, good dielectric and mechanical characteristics optimized by the anisotropic structure and a good impact, wear and temperature resistance from - 40 °C to + 110 °C.
- Certifications: The multipurpose suspension duct is marked CE and classified (with respect to the channel) in accordance with regulation CEI 23-32.

Accessories:

- 90° horizontal, internal and external vertical bends - Covers for 90° horizontal, internal and external vertical bends - 45° horizontal bends - Covers for 45° horizontal bends - Left and right reduction elements - Covers for left and right reduction elements - Separators - T branches - Covers for T branches - Mounting clip - Equipment support plates. All accessories are fibreglass. Horizontal and vertical deviation elements - Wall-mounted shelf - Rack-mounted shelf - Single or double suspension plate - Wall mount - Single or double suspension mount - Mounting bolts for shelf clamps. All is stainless-steel.

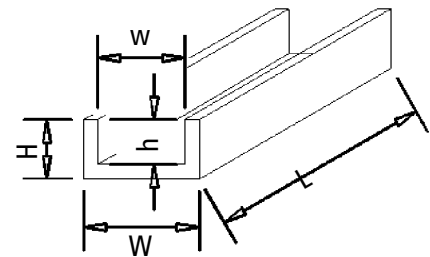
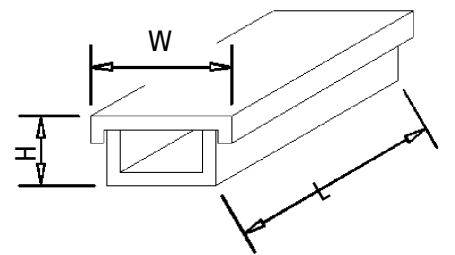

CV/H110 X 200-400

Fibreglass cable protection channels

Series CV/H80 X 100-300 / Series CV/H110 X 200-400

TECHNICAL INFORMATION

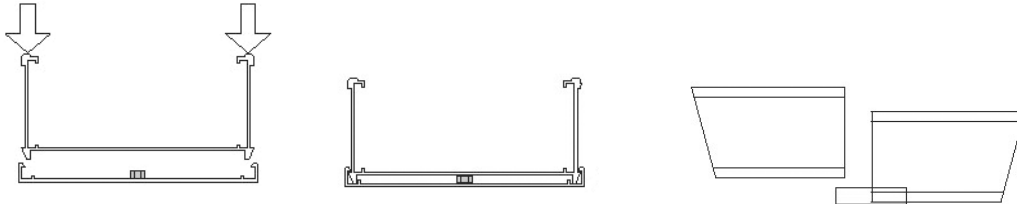

- Clamp adjoining elements by mounting clips.

Mounting clip

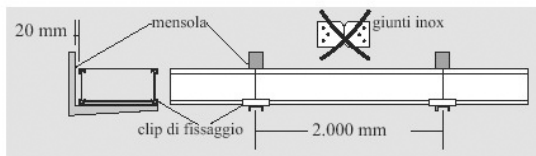

- Example of suspension mounting.

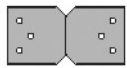

Branch joint - horizontal view

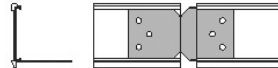

Screws and rivets are not necessary

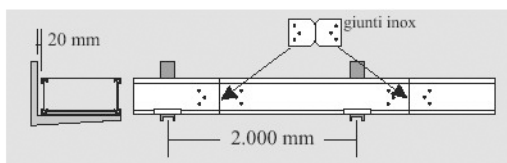

- Example of suspension mounting.